

Model 3135



3135 Wipe-On

Primary Applicator

Have a Label-Aire Authorized Distributor contact you. Visit www.label-aire.com.



3135 Wipe-On Specifications

The Label-Aire® Model 3135 makes labeling easier and faster...keeping you many steps ahead of your competition.

The Model 3135 Wipe-On labeler delivers on its promise of speed, accuracy, and ease of use. And that translates into lower operating costs and increased productivity for your business.

Speeds up to 3,500 inches (88.9 m) of web per minute make the Model 3135 an ideal choice for demanding applications requiring high speed and precision. Advanced features include Automatic Speed Following (ASF) which allows product surface profiling, ensuring wrinkle-free labeling on even the most difficult product shapes and label materials (optional encoder required). Zero Downtime Labeling allows your production to continue without costly interruptions. Product/label queuing and missing label compensation virtually eliminate unlabeled products or missing lot and expiration codes.

Put this high-speed wipe-on pressure-sensitive technology to work for you all day, every day. The Model 3135 Wipe-On labeler is built to meticulous quality standards and designed to withstand the most demanding operation.

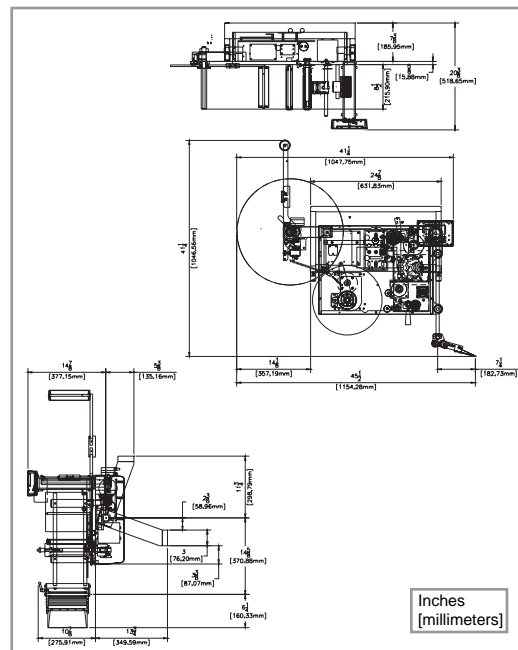

Dimensions:

Height: 32.68" (.83 m)
 Length: 41.25" (1.048 m)
 Width: 24.6" (0.63 m)

Weight:

Approx. 180 lbs. (84 kg)

Standard Label Dimensions:

Label Width: Up to 7.13" (181 mm)
 Label Length: 5" (13 mm)

Label Packaging:

20" (508 mm) O.D. rolls std. on
 3" (76 mm) I.D. cores
 with optional 6" (152 mm) core

Dispense Speed:

Up to 3,500" (88.9 m) of web per minute

Label Dispense Accuracy:

Up to +/- 1/64" (.4 mm)

Electrical:

115 Volts AC 60 Hz 3 Amps.
 220 Volts AC 50 Hz optional

Options:

Encoder kit for Automatic Speed Following
 6" (152 mm) label core adapter
 Hot stamp imprinter
 Model 2700 T-Base stand
 Strobe signals for "low label" and
 "out of labels"

Consult factory for additional options.

Distributed by:

MPI Label Systems
www.mpilabels.com
info@mpilabels.com
 866-364-3585

3135 Wipe-On Advanced Features

Automatic setup	Includes multiple programmable label pages for easy changeovers to different label sizes.
Stepper motor drive	For precise starting/stopping, increased reliability, wider range speed variability, and lower maintenance.
R3 digital display	Select from five languages (English, French, German, Italian, Spanish), domestic or CE (European) configurations, standard/metric unit display and detailed alarm messages. Can rotate 360°.
Automatic Speed Following (ASF)	Labels are accurately applied even through extreme changes in product line speed.
Quick-action collapsible rewind	Allows easy removal of scrap liner.



Headquarters

550 Burning Tree Road
 Fullerton, CA 92833 USA

o 714.449.5155
 f 714.526.0300
 e info@label-aire.com
 w www.label-aire.com

Europe

Sjællandsvej 27A
 DK-9500 Hobro, Denmark

o +45.9657.0063
 f +45.9657.0064
 e info@label-aire.com
 w www.label-aire.com

Asia

No. 10, Lane 228, Taisi S. Road
 Longjing Township
 Taichung County 434, Taiwan

o +886.4.2395.5684
 f +886.4.2395.8007
 e info@label-aire.com